



JOB NAME:

CAT#:

TYPE:

### APPLICATIONS

Extend the realm of your lighting capabilities with the Configure Series, an all-new flat panel hanging system. Customizable patterns can adapt to any space and allow for unlimited creativity. Build unique shapes and designs to add flare to your building interior. This series can be used to mimic skylights and works well in offices, retail environments, or residential buildings.

### FEATURES & BENEFITS

- 3 standard panel sizes – 2'x2', 1'x4', and 2'x4'
- Customizable bracket colors available
- Pendant mount for most ceilings
- Many lumen package / wattage options via programmable drivers
- CRI >80
- >50,000 hrs of L70 LED life
- Power factor >0.90

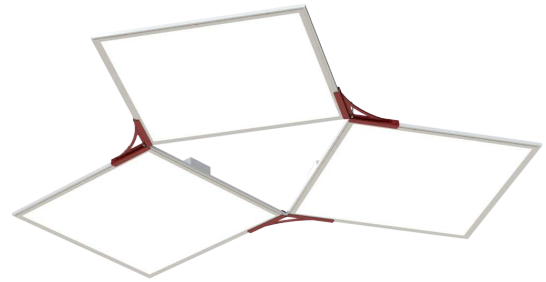

### DIMENSIONS

Part	W	L	W <sub>2</sub>	L <sub>2</sub>
2'x2' Panel	23.75"	23.75"	7.5"	0.4"
1'x4' Panel	99"	47.75"	3.75"	7.125"
2'x4' Panel	147"	47.75"	9.625"	0.3"

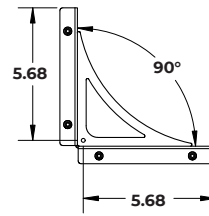
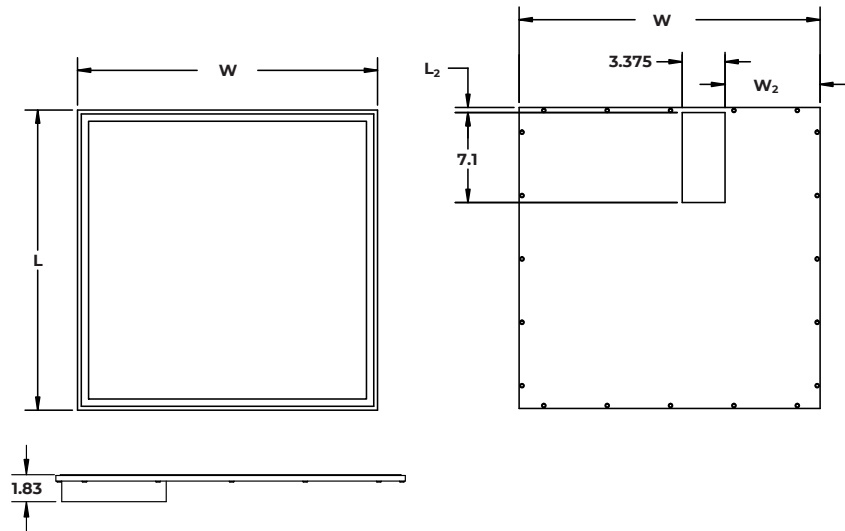

90° Bracket

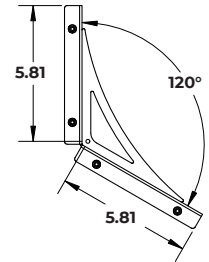

120° Bracket

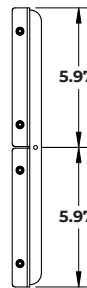

180° Bracket

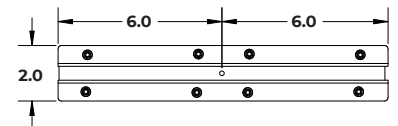

180° Double-Sided Bracket

Dimensions and specifications subject to change without notice.





JOB NAME:

CAT#:

TYPE:

**ORDERING**

EXAMPLE: MFPCS P 57X66 LED 120 DMV 30 RD EM -C01

MFPCS		P		LED			
1. SERIES	2. MOUNTING	3. WIDTH X LENTH <sup>1</sup>		4. GEAR	5. WATTAGE/LUMENS <sup>2</sup>		6. DRIVER
MFPCS	P Pendant	<b>57X66</b>	57"W x 66"L	<b>LED</b>		<b>-C01</b>	<b>DMV</b> 120-277V
		<b>48X48</b>	48"W x 48"L		<b>120</b>	120 Watts 15000 Lumens	Multivolt
		<b>60X60</b>	60"W x 60"L			<b>-C02</b>	0-10V
					<b>160</b>	160 Watts 20000 Lumens	Dimmable
						<b>-C03</b>	
					<b>160</b>	160 Watts 20000 Lumens	

7. COLOR TEMP		8. FLAIR <sup>3</sup>		9. EM (O) <sup>5</sup>		10. CONFIGURATION	
<b>30</b>	3000K	<b>RD</b>	Red	<b>EM</b>	10W Emergency	<b>-C01</b>	2x2 Triangular
<b>35</b>	3500K	<b>BL</b>	Blue		Battery	<b>-C02</b>	2x2 Square
<b>40</b>	4000K	<b>BK</b>	Matte		Backup <sup>4</sup>	<b>-C03</b>	1x4 Square
<b>50</b>	5000K		Black			<b>-C04</b>	2x4 Square

**Notes:**

<sup>1</sup>MFPCS configurations and patterns are measured by overall system width and length. Hanging kits come with 5' aircraft cables. Consult factory for other options.

<sup>2</sup>Wattage and lumen values are total for the system. Values will vary with each custom pattern.

<sup>3</sup>Consult for custom flair options

<sup>4</sup>Consult factory for other emergency options

<sup>5</sup>(O) is optional

Dimensions and specifications subject to change without notice.



JOB NAME:

CAT#:

TYPE:

**PATTERN OPTIONS**

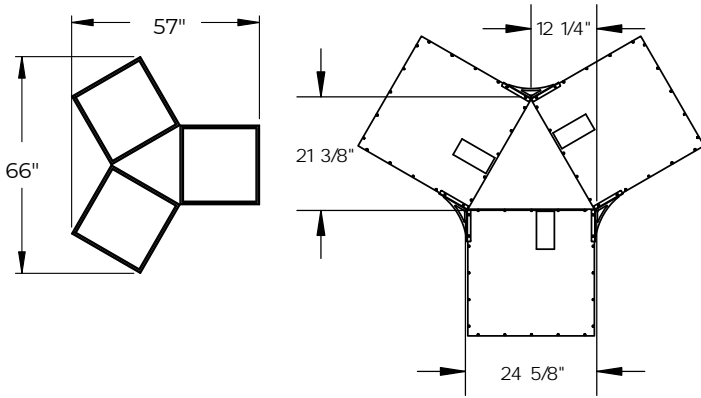

01- 2X2  
Triangular Array

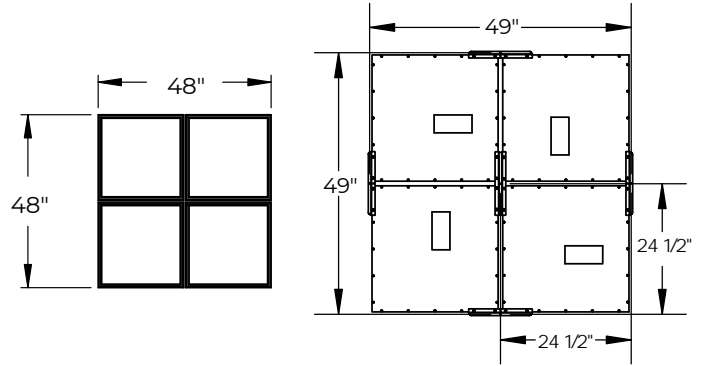

02 - 2X2 Square

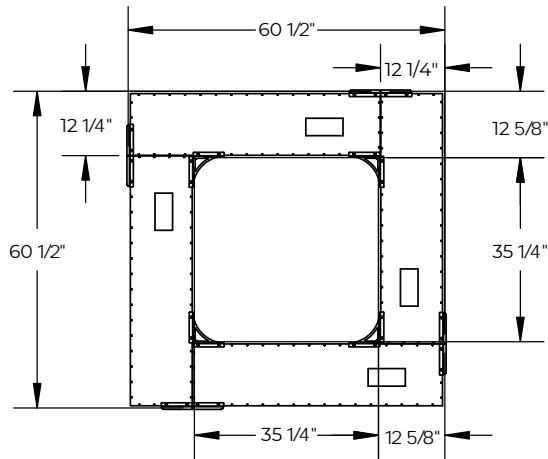
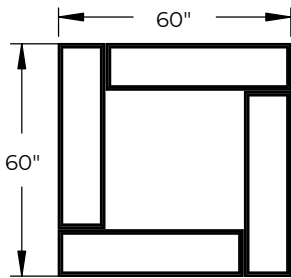

03 - 1X4 Square

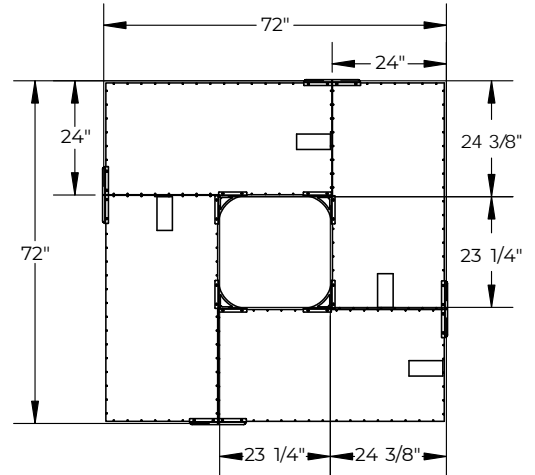
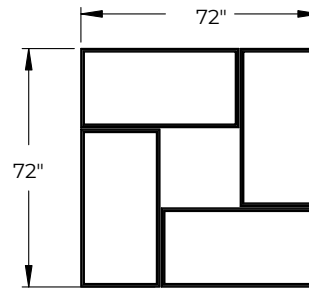

04 - 2X4 Square

**\*NOTE: The custom patterns shown are examples. To create your own pattern, please consult the factory. All custom patterns must have design and drawing approval.**

Dimensions and specifications subject to change without notice.



JOB NAME:

CAT#:

TYPE:

**PATTERN OPTIONS**

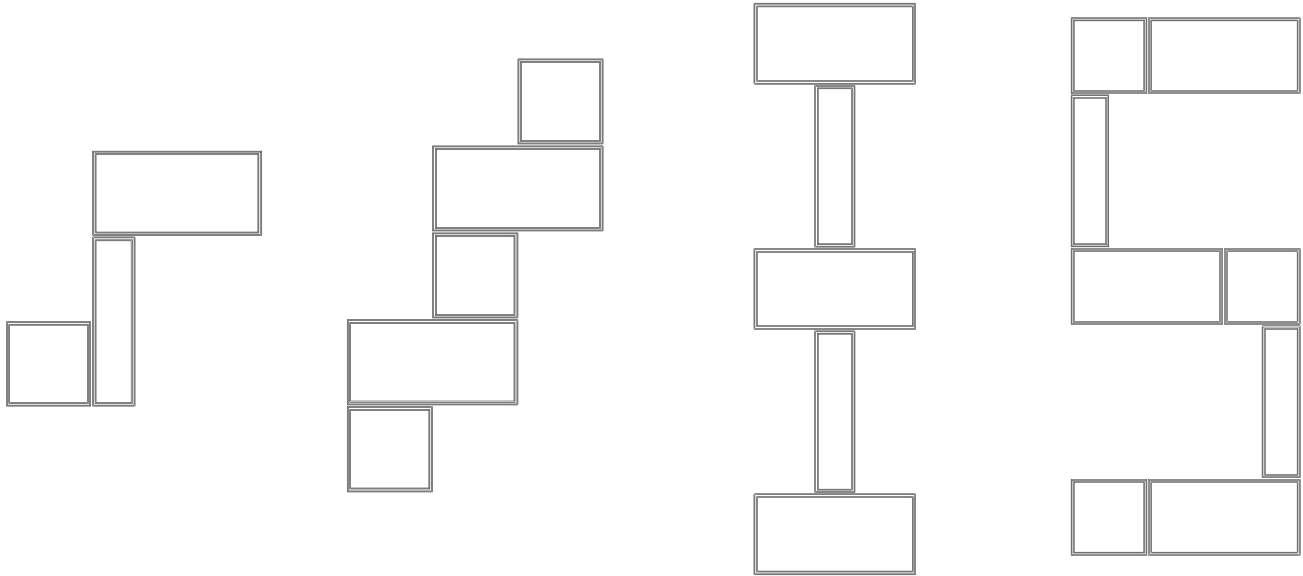

**\*NOTE: The custom patterns shown are examples. To create your own pattern, please consult the factory. All custom patterns must have design and drawing approval.**

Dimensions and specifications subject to change without notice.



JOB NAME:

CAT#:

TYPE:

**FLAIR BRACKET COLORS AND FINISHES**



Gloss Black  
(GB)



Matte Black  
(BK)

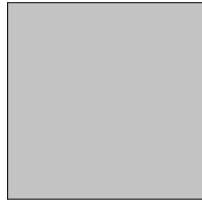

Matte Silver  
(SL)



Statuary Bronze  
(BZ)

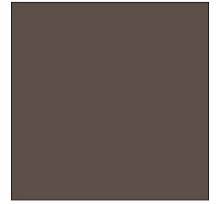

Glimmer (Iron)  
(IR)

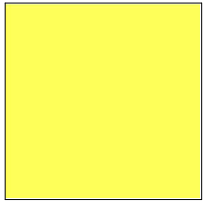

Safety Yellow  
(YL)

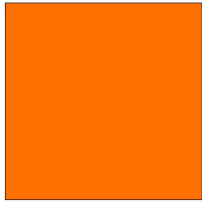

Safety Orange  
(OR)



Red  
(RD)



Fire Engine Red  
(FR)



Blue  
(BL)

**NOTE:** Factory offers any Tiger Drylac RAL finish, contact Saylite for more information. Consult factory for information on specialty "real wood" finishes.

Dimensions and specifications subject to change without notice.