

APPLICATIONS

Premium quality low profile troffer with an almost limitless range of applications. Ideal for all commercial and industrial buildings requiring general illumination with recessed configurations.

FEATURES & BENEFITS

- ◆ Min 80 CRI
- ◆ L70 life >60,000
- ◆ Corrosion and scratch resistant
- ◆ Smooth edges for easy handling
- ◆ Ends are secured by snap-in interlocking system
- ◆ .100 acrylic prismatic lens is standard
- ◆ Exclusive "Light Lock" frame reduces light leaks
- ◆ Flush steel door with rotary action cam latches and hinges from either side
- ◆ Easy access plate for quick wiring
- ◆ Equipped with Integral Earthquake Clips
- ◆ **ETL** listed for damp location
- ◆ L70 Life: reported- 54,000 hours, calculated- 117,000 hours



SPECIFICATIONS

Housing is die-formed and embossed from cold rolled steel. Wiring access plate and knockouts are provided on back of housing allowing for flexible greenfield attachment. Driver cover snaps easily into place eliminating the need for tools when accessing the driver. Prismatic lens is held within a hinged steel frame door. The heavy gauge door frame hinges downward on either side and is held in the closed position by two positive cam latches. Knockouts are provided on ends for continuous wiring. Listed by and bears **ETL** label.

ORDERING DATA

EXAMPLE: RG22P-LED22DMV40

RG		P		LED					
Series	Size	Suffix	Gear	Wattage / Lumens		Driver	Color Temp		
RG	14 1x4	P	LED	1x4		DMV Factory Installed Dimmable 120-277 VAC Multivolt 0-10V	30 3000K		
LED Grid	22 2x2	(Professional)		37 37 Watts	4380 Lumens,		35 3500K		
	24 2x4			2x2			40 4000K		
				22 22 Watts	2575 Lumens		50 5000K		
				2x4					
				37 37 Watts	4780 Lumens				
Options									
							EM	10W, 1300 lumen, battery backup	
							EM5	5W, 650 lumen, battery backup	
							EM7	7W, 900 lumen, battery backup	
							EM12K	1200 Board Lume LED Emergency Kit	
							Blank	A12 .100 thick lens	
							125	A12 .125 thick lens	
							156	A19 .156 thick lens	
							CL	Clear .100 thick lens	
							CL125	Clear .125 thick lens	
							SW	Smooth White .100 thick lens	
							S5	Specular Parabolic Louver (1/2"x1/2"x3/8")	
							S75	Specular Parabolic Louver (3/4"x3/4"x3/8")	
							S15	Specular Parabolic Louver (1 1/2"x1 1/2"x1")	
							W5	White Parabolic Louver (1/2"x1/2"x3/8")	
							NL	No Lens	
							NFL	No Frame and Lens	
							FR	High Optic Frosted	
							G3	Triple Gasketing	
							FA	Flush Aluminum	
							WP	6FT 3 wire whip	

DLC Listed	
RG14P-LED37DMVxx	xx=30,35,40,50
RG22P-LED22DMVxx	xx=30,35,40,50
RG24P-LED37DMVxx	xx=30,35,40,50

Dimensions and specifications subject to change without notice.



◆ 800-444-WATT ◆ www.mobern.com ◆
8200 Stayton Dr., Ste. 500, Jessup, MD 20794

CAT#

JOB NAME

TYPE

Dimensions

TOP VIEW

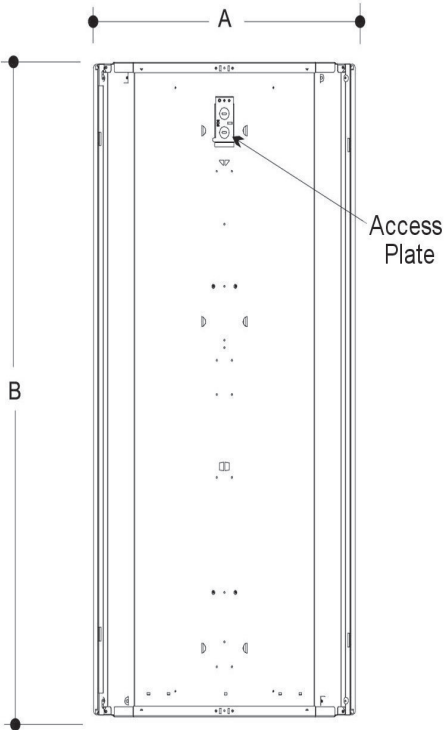

SIDE VIEW

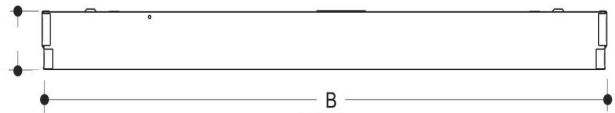

END VIEW

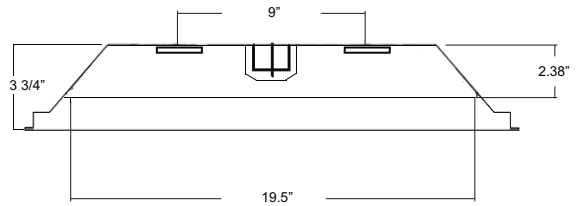

Dimensions and specifications subject to change without notice.



◆ 800-444-WATT ◆ www.mobern.com ◆
8200 Stayton Dr., Ste. 500, Jessup, MD 20794

CAT#

JOB NAME

TYPE