

APPLICATIONS

The MILGRFLT is a corrosion resistant Flood Light designed to provide the long life and high reliability required in industrial and commercial applications. These lights are ideal for providing safety and security along building perimeters. Applications include parking lots, garages, and commercial buildings.

FEATURES & BENEFITS

- ◆ Uses up to 88% less energy than HID equivalent
- ◆ 3-5x longer life than fluorescent or HID systems
- ◆ Mercury and UV free with RoHS certified LEDs
- ◆ Designed and Assembled in the USA
- ◆ Instant On/Off

Mobern's LED Flood is a corrosion resistant 9"x16" floodlight. This flood provides excellent illumination for safety and security and are designed for an extended life and high reliability in industrial and commercial applications.



IP65
CERTIFIED

28W - 84W

Replaces
Up to 400W MH

SPECIFICATIONS

- ◆ Housing: Die Cast Aluminum
- ◆ Finish: Weather Resistant Dark Bronze Powder Coat
- ◆ Lens: Clear Heat and Impact Resistant Glass
- ◆ Mounting Options: (sold separately) trunnion, slip fitter, swivel, or straight arm
- ◆ Operating Voltage: 100~277 VAC 50/60Hz
- ◆ Power Factor: >0.98
- ◆ Max Ambient Temp: 110°F
- ◆ Rated Life: 85000 HRS
- ◆ Environment: Indoor/Outdoor; Wet Location
- ◆ ^cETL_{US} listed, IP65 Rated
- ◆ CONFORMS TO: UL-8750, UL-1598, CSA22.2

ORDERING DATA

EXAMPLE: MILGRFLTLED28MV50

MILGRFLT		LED		Driver*		Color Temp	
Series	Gear	Wattage		Driver*		Color Temp	
MILGRFLT	LED	28	28 Watts	MV	120-277VAC	30	3000K
LED Flood		42	42 Watts			40	4000K
Light		56	56 Watts			50	5000K
		70	70 Watts			55	5500K
		84	84 Watts				

*Consult for 0-10V Dimming

ACCESSORIES

- A-R300755 Photocell 120VAC
- A-R300765 Photocell 208/277VAC
- A-R300664 Trunnion Bracket
- A-R300684 Heavy Duty Swivel
- A-R392098 6" Straight Arm

Dimensions and specifications subject to change without notice.



TECHNICAL DATA

Model	Input Watts	Initial Lumens (lm)	Efficacy (lm/W)	CRI
MILGRFLTLED28	28W	2760	98.5	>80
MILGRFLTLED42	42W	4320	102.8	>80
MILGRFLTLED56	56W	5320	95	>80
MILGRFLTLED70	70W	7025	100.3	>80
MILGRFLTLED84	84W	8420	100.2	>80

*Technical Data reflect nominal values.

DIMENSIONS

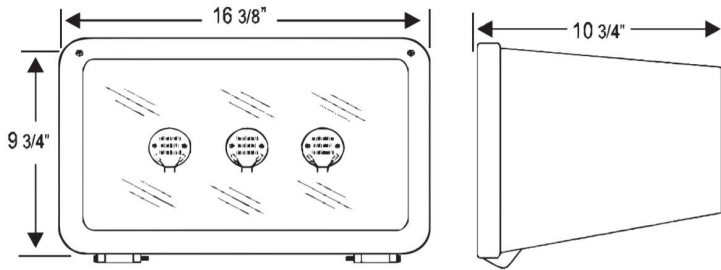

WARRANTY

Mobern Lighting Company warrants to the purchaser that this LED Fixture will be free from defects in material or workmanship for a period of 5 years from date of manufacture, when operated at a maximum ambient temperature of 110°F or 45°C, when properly installed and under normal conditions of use.

Dimensions and specifications subject to change without notice.



◆ 800-444-WATT ◆ www.mobern.com ◆

8200 Stayton Dr., Ste. 500, Jessup, MD 20794

CAT#

JOB NAME

TYPE