

### APPLICATIONS

The Mobern Flex Pro Series of Luminaires is a customizable LED Area Light designed around a sleek, multi-purpose built housing and features an array of wattage and color temperature options. The Flex Pro Series is your perfect choice for achieving the highest energy efficiency while maximizing light output. With multiple mounting options available, this area light is ideal for general area lighting, parking lots, walkways, underpasses and other pedestrian areas.

### FEATURES & BENEFITS

- ◆ Housing is a Die-Cast Aluminum
- ◆ High Quality Powder Coat Silver Finish
- ◆ Lens is Clear Acrylic
- ◆ Mounting from 12 to 50 Feet
- ◆ LED Gear is a linear array of Bridgelux LED's 20x1W LED per each board
- ◆ 100 - 277VAC 50/60Hz
- ◆ Rated Life of 50,000 hrs
- ◆ cULus Listed for Wet Location
- ◆ 115 Lm/W
- ◆ 5 Year Standard Warranty



CANOPY



60W - 250W

Replaces  
Up to 1000W MH



### SPECIFICATIONS

Die Cast Aluminum Housing finished in a High Quality Powder Silver Finish. The fixtures are specification grade customizable build around a common core housing. LED gear is Bridgelux and Meanwell drivers. IP66; carrying a 5 year system warranty standard. Listed and bears a cULus label for wet location.

### ORDERING DATA

EXAMPLE: MFPALED60MV41BK

MFP		LED		Voltage		Color Temp		Finish		Options		
Series	Fixture Type	Gear	Wattage / Lumens									
<b>MFP</b>	<b>A</b> Area	<b>LED</b>	<b>60</b>	60 Watts 8880 Lumens	<b>MV</b>	Multi-Volt	<b>30</b>	3000K	<b>Blank</b>	Silver (std)	<b>40D</b>	40° Beam Angle
Flex Pro	<b>C</b> Canopy		<b>100</b>	100 Watts 14390 Lumens		120-277	<b>35</b>	3500K	<b>BK</b>	Black		Type V
LED Light	<b>F</b> Flood		<b>120</b>	120 Watts 17770 Lumens			<b>41</b>	4100K	<b>BZ</b>	Bronze	<b>80D</b>	80° Beam Angle
	<b>HB</b> High Bay		<b>150</b>	150 Watts 22050 Lumens			<b>50</b>	5000K	<b>DG</b>	Dark Gray		Type V
	<b>PT</b> Post Top		<b>200</b>	200 Watts 29540 Lumens			<b>60</b>	6000K			<b>170D</b>	170° Beam Angle
	<b>W</b> Wall Mount		<b>250</b>	250 Watts 36040 Lumens								Type V
			<b>300</b>	300 Watts 44575 Lumens								Type IV
												T3 Type III
												T2 Type II
												T1 Type I

\*Based on 4100K

Dimensions and specifications subject to change without notice.



◆ 800-444-WATT ◆ www.mobern.com ◆  
8200 Stayton Drive, Ste. 500. Jessup, MD 20794

CAT#	
JOB NAME	TYPE

### PHOTOMETRIC DATA

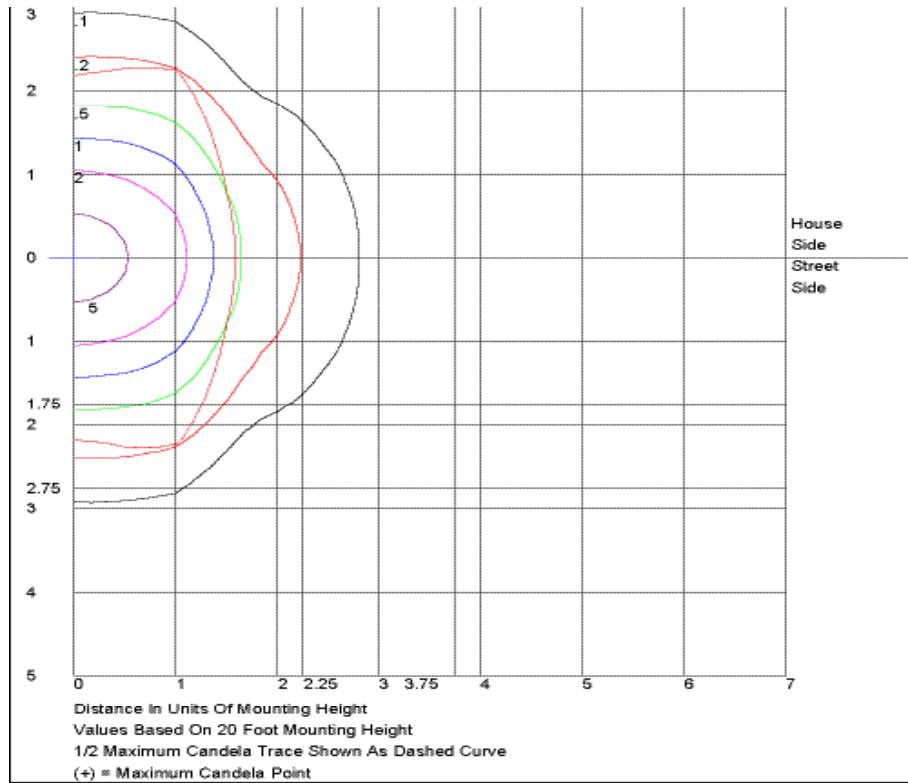

#### IES ROAD REPORT PHOTOMETRIC FILENAME : MFPA100LED.IES

##### CHARACTERISTICS

IES Classification	Type VS
Longitudinal Classification	Very Short
Lumens Per Lamp	103.6 (100 lamps)
Total Lamp Lumens	10360
Luminaire Lumens	10321
Downward Total Efficiency	100 %
Total Luminaire Efficiency	100 %
Luminaire Efficacy Rating (LER)	103
Total Luminaire Watts	100
Ballast Factor	1.00
Maximum Candela	3060.344
Maximum Candela Angle	90H 0V
Maximum Candela (<90 Degrees Vertical)	3060.344
Maximum Candela Angle (<90 Degrees Vertical)	90H 0V
Maximum Candela At 90 Degrees Vertical	37.938 (0.4% Lamp Lumens)
Maximum Candela from 80 to <90 Degrees Vertical	946.904 (9.1% Lamp Lumens)
Cutoff Classification (deprecated)	Cutoff

Watts	Lumens	Efficacy	Modules	X" (width)	EPA
60	6900	115 LM/W	2	10.7"	1.884
100	11780	115 LM/W	3	13.5"	2.292
120	14130	115 LM/W	4	16.3"	2.712
150	17240	115 LM/W	5	19.1"	3.12
200	23220	115 LM/W	6	21.9"	3.528
250	28800	115 LM/W	7	24.7"	3.948

Dimensions and specifications subject to change without notice.



◆ 800-444-WATT ◆ www.mobern.com ◆

8200 Stayton Drive, Ste. 500, Jessup, MD 20794

CAT#

JOB NAME

TYPE

### DIMENSIONS

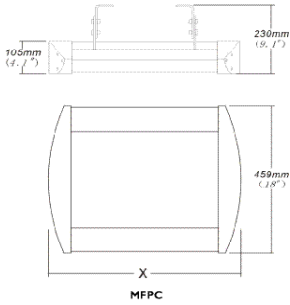

MFPC



MFPP

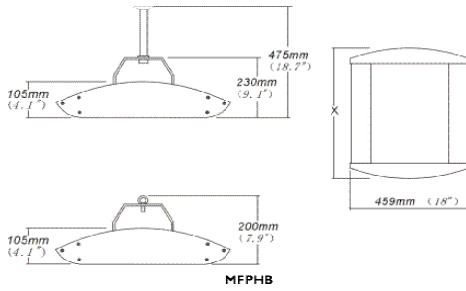

MFPHB



MFPHB

\* Consult about Pendant Mount  
\* Eye Hook standard



MFPA



MFPPT



MFPPF

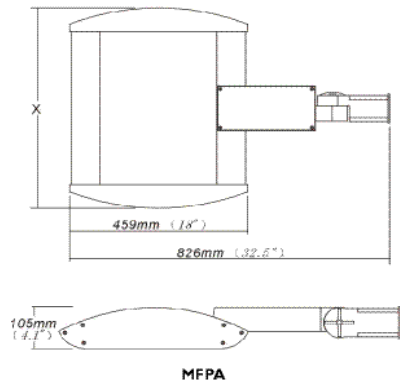

MFPA

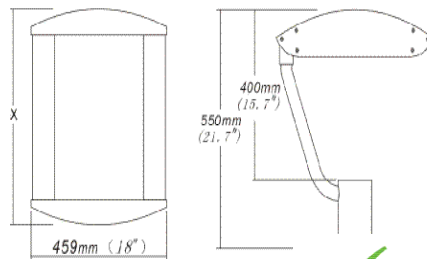

MFPPT

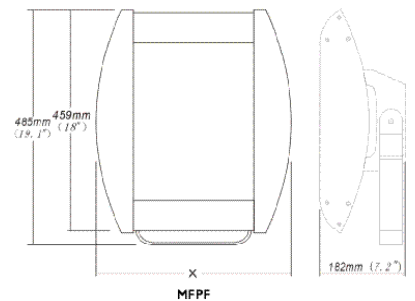

MFPPF



Dimensions and specifications subject to change without notice.

◆ 800-444-WATT ◆ www.mobern.com ◆  
8200 Stayton Drive, Ste. 500, Jessup, MD 20794

CAT#

JOB NAME

TYPE