

APPLICATIONS

High efficiency LED engineered for premium performance in medium and high ceiling applications ideally suited for warehouses, manufacturing plants, sports facilities and retail spaces. A precision-formed reflector system available in highly reflective enhanced white reflector achieve maximum light output for ceilings from 15 feet to 40 feet. The unique arrangement is ideal for wide area lighting to put the light exactly where you need it with less fixtures. Based on ceiling height, these fixtures can replace an HID high bay using half of the wattage. Surface, pendant, chain or stem mounting. Highest quality materials and workmanship.

FEATURES & BENEFITS

- ◆ Designed for surface, pendant, stem or chain hanging
- ◆ Mounting holes provided for simple, fast installation
- ◆ Min CRI 80
- ◆ cETL_{US} Listed

SIZE: W x L x H in inches

24L: 15.575W x 23.379"L x 4.296"H
48L: 15.575W x 45.160"L x 4.296"H



APPLICATIONS

Housing is 22 gauge prepainted steel. Air vents surround the drivers in the back of the fixture to maximize LED and driver performance, reliability and life. High reflective enhanced white reflectors are computer designed to maximize photometric performance and put the light where you need it. Access plate in the back makes wiring fast and hassle-free. Back of fixture is designed with built-in mounting holes for tong hanger, cable kit and surface mount.

ORDERING DATA

EXAMPLE: HBPA24-LED80DMVFR40

HBPA		LED		DMV			
Series	Size	Gear	Wattage & Lumens		Driver	Lens	Color Temp
HBPA	24 23.379" 48 45.160"	LED	24 80 80 Watts 10000 Lumens 122 122 Watts 15000 Lumens 175 175 Watts 21525 Lumens 48 80 80 Watts 10000 Lumens 122 122 Watts 15000 Lumens 149 149 Watts 21150 Lumens 175 175 Watts 25050 Lumens 186 186 Watts 26350 Lumens 215 215 Watts 31380 Lumens 220 220 Watts 33000 Lumens 260 260 Watts 36780 Lumens 273 273 Watts 38230 Lumens 280 280 Watts 41120 Lumens 315 315 Watts 45440 Lumens 355 355 Watts 50110 Lumens		DMV 0-10V Dimming 120-277VAC Multivolt	Blank No Lens FR Frosted CL Clear lens	30 3000K 35 3500K 40 4000K 50 5000K
LED Module Distribution (Blank) Downlight Only U Uplight Only 1U2D Up and Downlight			Options OS Occupancy sensor Wide angle OSD Occupancy and daylight sensor w/ dimming EM 10W 1300 lumen Battery backup CS8 8' cord, no plug CS12 12' cord, no plug WG Wireguard				

*See chart below for whip & cord ordering options

*Cord & Whip Ordering Chart (Add to End of Fixture Part Number)

Part No.	# of Wires	Length	End Fitting	Finish	Voltage	Amps (TL Only)
WP - Whip	(Blank) 3 Wire	(Blank) 6 feet	(Blank) No Plug	BK - Black	(Blank) 120-277V	15 - 15 Amps
CS - Cordset	4 - 4 Wire	8 - 8 feet	P* - Standard Plug	WH - White	120 - 120V	20 - 20 Amps
	5 - 5 Wire	10 - 10 feet	TL* - Twist Lock		277 - 277V	
	6 - 6 Wire	12 - 12 feet			347 - 347V	
		15 - 15 feet			480 - 480V	

Note: Wire guard is optional

Dimensions and specifications subject to change without notice.



ACCESSORIES

- A-HBPA24WG** Wireguard for HBPA24
- A-HBPA48WG** Wireguard for HBPA48
- AC120-Toggle-2PK** Yhook - 10' Cable Mounting Kit and 2 Spring Clips

DLC INFORMATION

DLC Listed Fixtures		
Model Number	Color Temp	Options
HBPA48-LED175DMVxx	xx= 30,35,40,50	OS, OSD, WPx, EM, CSxx
HBPA48-LED215DMVxx	xx= 30,35,40,50	OS, OSD, WPx, EM, CSxx
HBPA48-LED220DMVxx	xx= 30,35,40,50	OS, OSD, WPx, EM, CSxx
HBPA48-LED260DMVxx	xx= 30,35,40,50	OS, OSD, WPx, EM, CSxx
HBPA48-LED280DMVxx	xx= 30,35,40,50	OS, OSD, WPx, EM, CSxx
HBPA48-LED315DMVxx	xx= 30,35,40,50	OS, OSD, WPx, EM, CSxx
HBPA48-LED355DMVxx	xx= 30,35,40,50	OS, OSD, WPx, EM, CSxx



DIMENSIONS

24L

TOP VIEW WITHOUT LENS

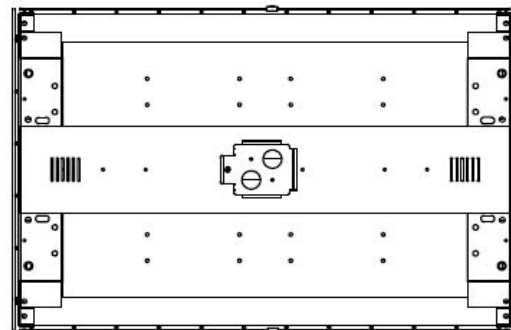
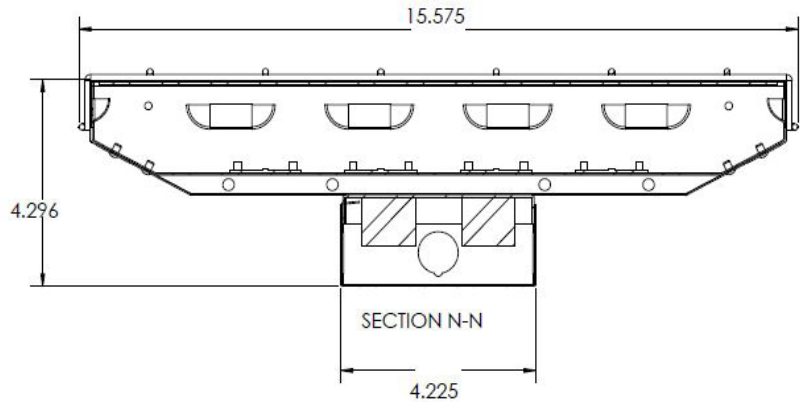
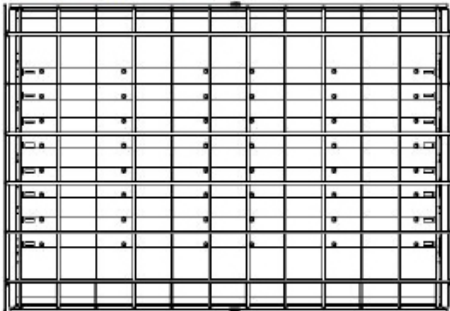

BOTTOM VIEW

Dimensions and specifications subject to change without notice.



◆ 800-444-WATT ◆ www.mobern.com ◆
8200 Stayton Dr., Ste. 500, Jessup, MD 20794

CAT#

JOB NAME

TYPE

DIMENSIONS

48L

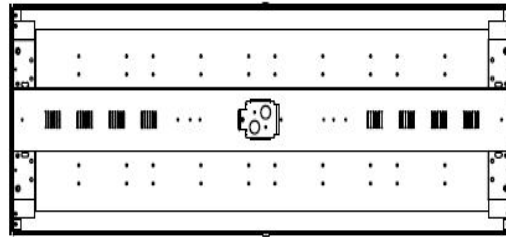
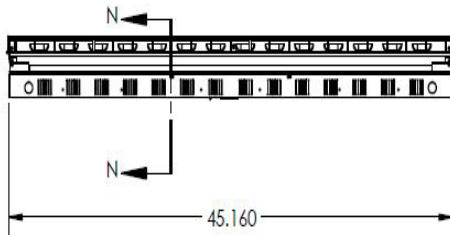
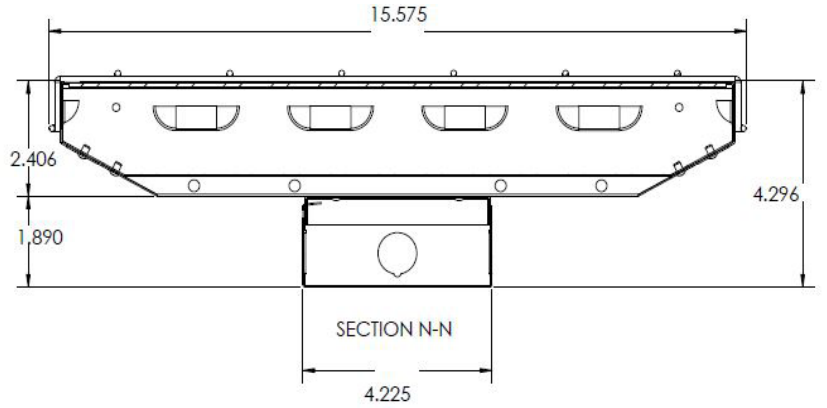
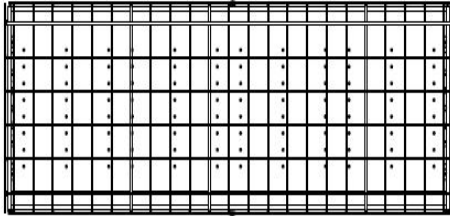

Bottom View

Dimensions and specifications subject to change without notice.

